

## INSTALLATION GUIDE: KnuckleHead Rooftop Support System

### STEP 1

#### LAYOUT THE ASSEMBLY

Use a marker to indicate the location of all Universal Bases, when bonding the base with GREEN LINK Adhesive/Sealant, which is optional.



### STEP 2

#### SURFACE PREPARATION

Using solvent such as rubbing alcohol, clean application area, removing dirt and oil.



NOTE: If loose laying the bases, then no cleaning is required. Set base into KnucklePad (OPTIONAL) and proceed to STEP 6.



### STEP 3

(OPTIONAL)

#### APPLICATION OF ADHESIVE/SEALANT

If bonding the base to the roof membrane, apply GREEN LINK Adhesive/Sealant to the bottom of the Universal Base. Using a notch trowel, comb the entire surface leaving a uniform, approximately 60-mil layer of GREEN LINK Adhesive/Sealant.



#### STEP 4

(OPTIONAL)

#### PLACEMENT OF THE BASE

Position the base in the marked area and press gently. GREEN LINK Adhesive/Sealant should squeeze out from the “rivet holes.”



#### STEP 5

(OPTIONAL)

#### MECHANICAL ATTACHMENT

If also mechanically attaching the Universal Base to the deck, engage the appropriate fastener into the deck. (KnucklePads are not utilized when mechanically attaching base). Apply GREEN LINK Adhesive/Sealant to the fastener head to prevent leaking.

**CAUTION!** It is recommended to contact the roof system manufacturer to make sure all specifications and requirements are followed. Failure to do so could void the roof warranty.



## STEP 6

(OPTIONAL)

### INSTALLING EXTENSIONS

If the installation is to be elevated, slide the appropriate extensions into the base.



## STEP 7

### INSTALLING THE HEAD

Mate the KnuckleHead to the base (or extension) and level, if necessary. NOTE: Rotate the head to the desired height, but do not elevate above the “stop” mark, which can compromise the integrity of the KnuckleHead unit.

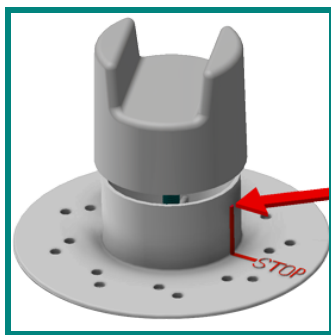

NOTE: Rotate the head to the desired height, but do not elevate above the “stop” mark, which can compromise the integrity of the KnuckleHead unit.



#### STEP 8

#### PLACEMENT OF STRUT, PIPE OR PAVER

Set strut, pipe or paver onto the head, when using metal strut, apply GREEN LINK Adhesive/Sealant to the strut head (optional) and press into place. NOTE: If setting pavers, a GREEN LINK anti-vibration PaverPad can be set on the head.



NOTE: If setting pavers, a GREEN LINK anti-vibration PaverPad can be set on the head.



#### STEP 9

#### SECURING THE PLACEMENT

KnuckleStraps and -Caps install using standard stainless steel sheet metal screws (included).  
KnuckleClips do not require screws—they twist and snap in place along the strut channel.